

Lambert Road, Brixton, SW2

1 bedroom flat - conversion to let

£439 Per Week

Unfurnished

Property Details

A delightfully one double bedroom garden flat set in a sought after Victorian terraced house on Lambert Road. This lovely flat feels like a home, the moment you walk through the door and into the bright open plan reception/kitchen on the ground floor. Benefitting from large sash windows, there is an abundance of natural light. The kitchen is modern and provides good worktop space, a sleek bathroom and to the rear of the property is a generous sized double bedroom with direct access to you very on private garden, perfect for those summer days.

Lambert Road is an attractive Victorian residential street nestled in a popular, quiet pocket, highly sought after for its character, feel and proximity to Brockwell Park, Brixton town centre and Herne Hill beyond. Situated a nine-minute stroll to the culinary mecca of South London, Brixton, also have the popular establishments on Brixton Hill within touching distance, including F Mondays, Stir Coffee, Pizza Brixton and the White Horse Pub.

Living here you will have the best of both worlds with everything on offer in the hustle and bustle of central Brixton, but able to retire to the quieter village-like community that has been developed around Brixton Hill. First stop on the Victoria Line at Brixton tube station is a short stroll, whisking you into central London and the City within a few minutes. The buses offer a great alternative to the tube and train stations for commuters into Zone 1.

Council tax band C **EPC rating C (70)**

Features

- One double bedroom
- Private garden
- Victorian conversion
- Bright and airy throughout
- Local amenities of Central Brixton
- Short walk to Brixton tube station
- Walking distance to Brockwell Park



Lambert Road, Brixton, SW2

Lambert Road, Brixton, SW2

1 Bedroom Flat

Approximate internal area: **494 sqft 46 sqm**

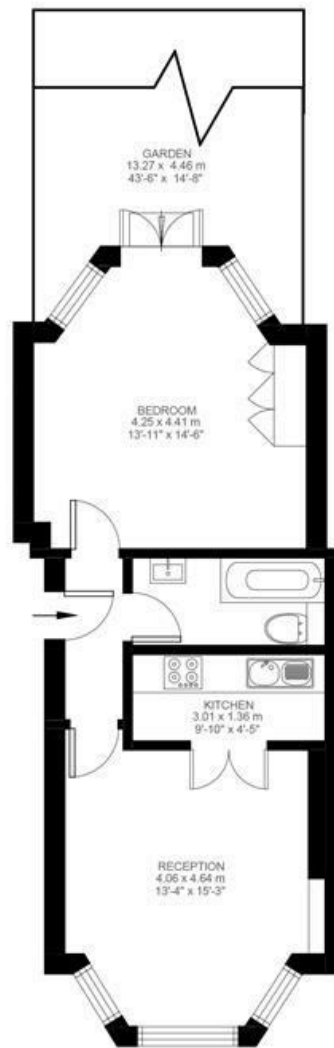

Ground Floor



While we do try our very best, floor plans are produced as a guide only and we take no responsibility for the precise accuracy with which any property is represented.

Lambert Road, Brixton, SW2

